



How to wash 3D printed models?

After removing your 3D model from the building plate, the prints must be cleaned, washed, and post-processed thoroughly. The following guide includes three washing methods: the dunk and wash method, washing in Wash from Wash & Cure Kit, and the Ultrasonic Cleaner method.

THE DUNK AND WASH

Step 1: Fill two basins with Phrozen Wash or 95% alcohol, IPA.

Step 2: Rinse your 3D model in each basin and rinse for roughly 1 minute. Continue to wash the model until its surface is clean.

Tip:

You may use a soft brush and lightly brush the model for better results. However, a toothbrush is not recommended as it may cause scratches on the 3D print.

Danger:

DO NOT immerse your models for long periods of time into sanitizing alcohol, as this may cause models to break.

Step 3: Once it's done, place the 3D model to dry in a shaded area for 30-60 minutes before moving onto the post-curing process. You can also use a compressed air gun to fasten the process.

Step 4: After ensuring the 3D model is dry, you can now move onto the post-curing process.

CLEANING WITH PHROZEN ULTRASONIC CLEANER

Step 1: Fill the one basins the Phrozen Ultrasonic Cleaner with Phrozen Wash.

Step 2: Carefully place your 3D model into the basket of the Ultrasonic Cleaner.

Step 3: Turn ON the device by pressing the ON/OFF button on the right of the front panel.

Danger:

Cleaning liquids may become flammable and could evaporate fast, so please make sure you do not use the heating function. Make sure to operate the device within sight.

Step 3: Once the cleaning process is over, switch off the Ultrasonic Cleaner, and then remove the model from the basket.

Step 4: Place the 3D model to dry in a shaded area for roughly 30-60 minutes before moving onto the post-curing process. You can also use a compressed air gun to fasten the process.

Step 5: After ensuring the model is dry, you can now move on to the post-curing process.

Tip:

After cleaning, make sure to store the cleaning liquid in an airtight container and avoid exposing it to direct sunlight.

THE WASH FROM WASH AND CURE KIT

Step 1: Fill the basket of Wash machine with Phrozen Wash or 95% alcohol, IPA.

Step 2: After printing is completed hang the building plate with prints on the cleaning basket (if the building plate is smaller than 7", use the basket holder). For building plate over 10" put the prints straight into the cleaning basket.

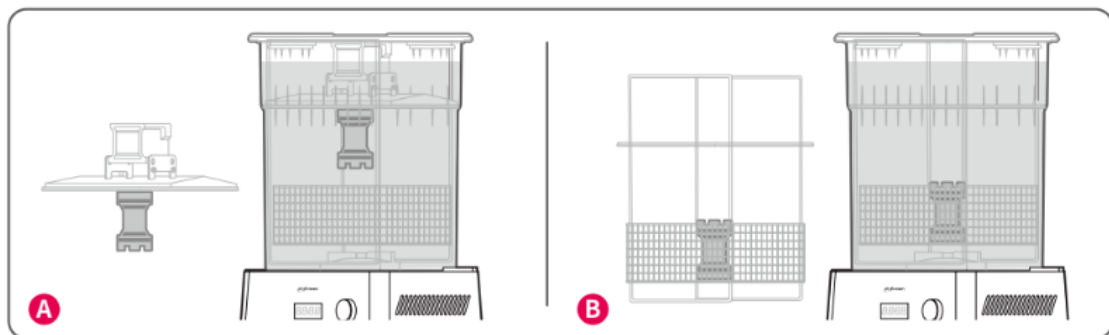

Step 3: Turn the knob to adjust the time and press to set. It is recommended that each cleaning time should not exceed 30 seconds as overcleaning might damage the prints.

Step 4: After the timer stops, lift the basket vertically and take out the prints.

Step 5: Leave prints to dry or use an air gun to accelerate the drying process.

Step 6: For hollow and more complicated models, please make sure the prints are clean. If any residual resin was found, repeat steps 3-5.

Step 7: After the cleaning process is completed, put prints into the curing machine to cure.

Tip:

Regularly replace 95% alcohol (cleaning fluid) for optimum results.